

Variable Star Ornament – Dark Blue

From white print, cut:

1 – 2 3/4" square, cutting it diagonally twice in an X for 4 large triangles total

B

4 – 1 1/4" squares A

From dark blue, cut:

4 – 1 5/8" squares, cutting each in half diagonally for 8 small triangles total

C

1 – 2" square D

From light blue, cut:

4 – 1 1/4" X 5" binding strips

1 – 4" square for backing

From batting, cut:

1 – 4" square

Referring to Diagram, sew small blue triangles to short edges of white large triangle to make a Flying Geese unit. Press seams toward darker fabric. Repeat to make four Flying Geese units.

Sew together white 1 1/4" squares, Flying Geese units, and blue 2" square in three rows, referring to diagram for placement. Press seams away from Flying Geese units.

Join rows to make ornament top. Press seams toward center row.

Variable Star

Key Block (83/100 actual size)

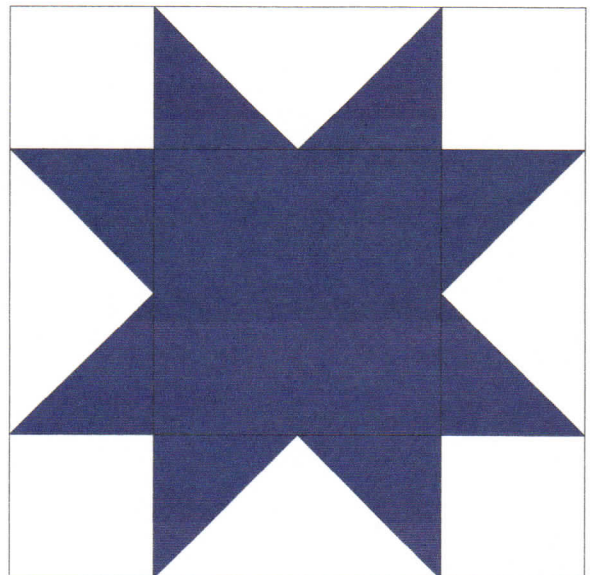
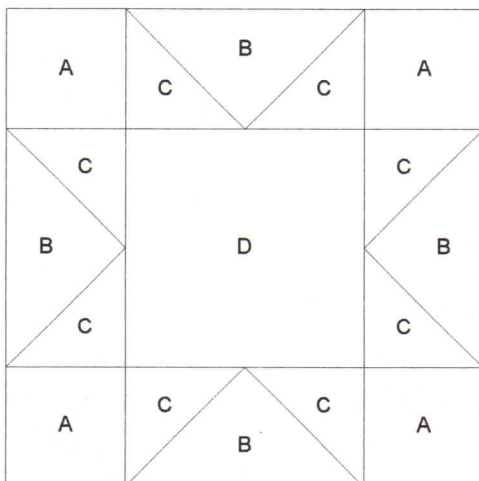

Friendship Star Ornament – Dark Blue

From white print, cut:

4 – 1 1/2" squares

5" x 1 1/2" piece for thangles

From dark blue, cut:

1 – 1 1/2" square

5" x 1 1/2" piece for thangles

From light blue, cut:

4 – 1 1/4" X 5" binding strips

1 - 4" square for backing

From batting, cut:

1 – 4" square

Make four half-square triangle blocks using thangle paper.

Sew together white 1 1/2" squares, half-square triangles, and blue 1 1/2" square in three rows referring to picture for layout. Press seams away from half-square triangles.

Join rows to make ornament top. Press seams toward center row.

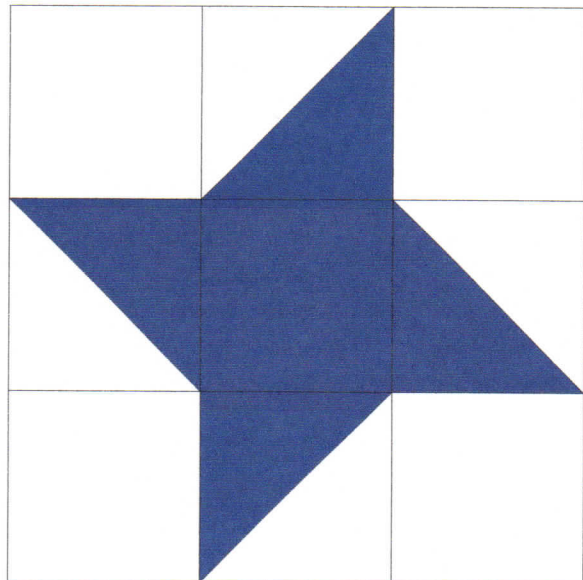

Aunt Eliza's Star Ornament

From white print, cut:

1 – 2 1/4" squares

5 – 1 1/2" squares

From dark blue, cut:

2 – 2 1/4" squares

From light blue, cut:

1 – 2 1/4" squares

4 – 1 1/4 X 5" binding strips

1 – 4" square for backing

From batting, cut:

1 – 4" square

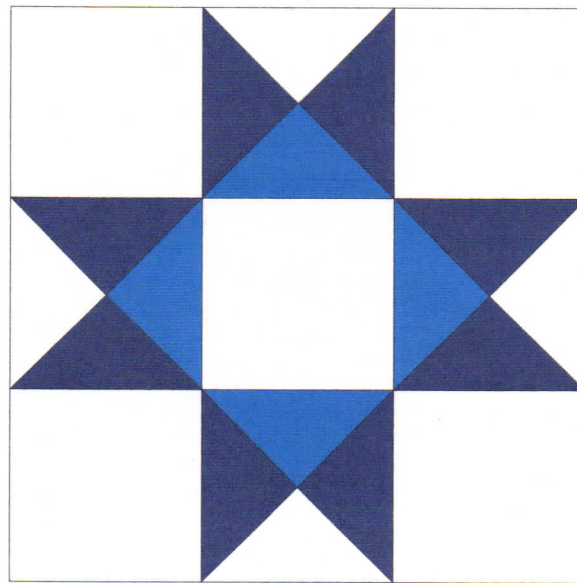

Pair one white and one dark blue square with right sides together. Draw a diagonal line from one corner to the opposite corner on the wrong side of the white fabric. Draw two more lines, each one 1/4" from the diagonal line. Sew along both lines that are 1/4" from center. Cut along center line and you will end up with two half-square triangles. Press seam to the dark blue side. Cut these units from corner to corner perpendicular to the seam. You will have 4 quarter square triangle units. Create second set of quarter square triangle units by pairing one light blue and one dark blue square with right sides together. Repeat above process to create 4 more quarter square triangle units. Making sure colors are correct, nest two quarter square triangle units together and sew along long seam to create two squares. Repeat. Diagram of process is included.

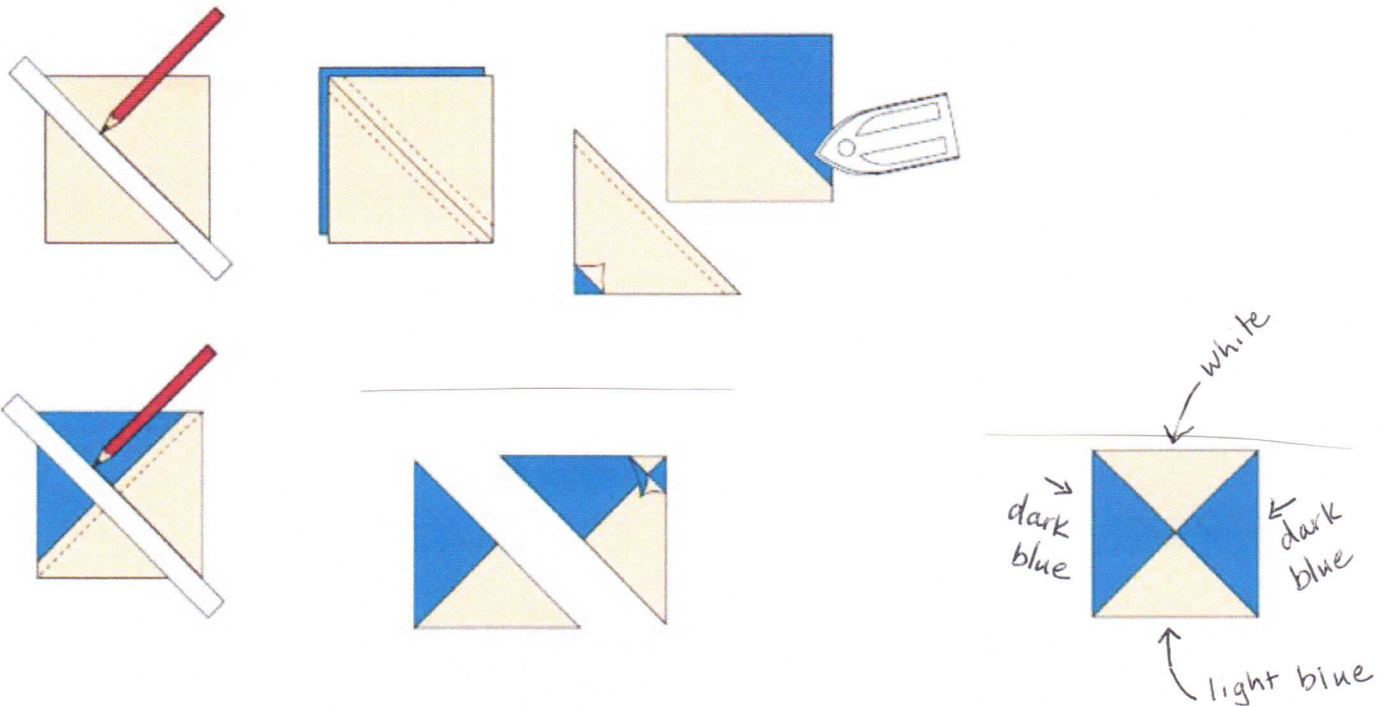

Ohio Star Ornament – Dark Blue

From white print, cut:

2 – 2 1/4" squares

4 – 1 1/2" squares

From dark blue, cut:

2 – 2 1/4" squares

1 – 1 1/2" square

From light blue, cut:

4 – 1 1/4 X 5" binding strips

1 – 4" square for backing

From batting, cut:

1 – 4" square

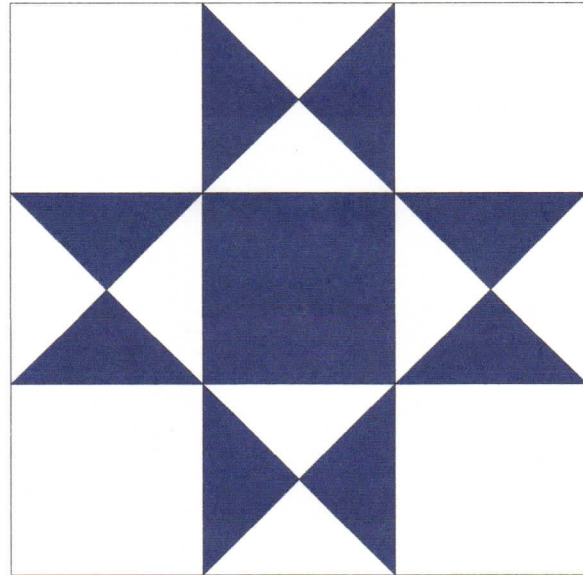

Pair one white and one blue square with right sides together. Draw a diagonal line from one corner to the opposite corner on the wrong side of the white fabric. Draw two more lines, each one 1/4" from the diagonal line. Sew along both lines that are 1/4" from center. Cut along center line and you will end up with two half-square triangles. Press seam to the blue side. Cut these units from corner to corner perpendicular to the seam as is indicated by the following diagram. You will have 4 quarter square triangle units. Making sure colors are correct, nest two quarter square triangle units together and sew along long seam to create two squares. Repeat.

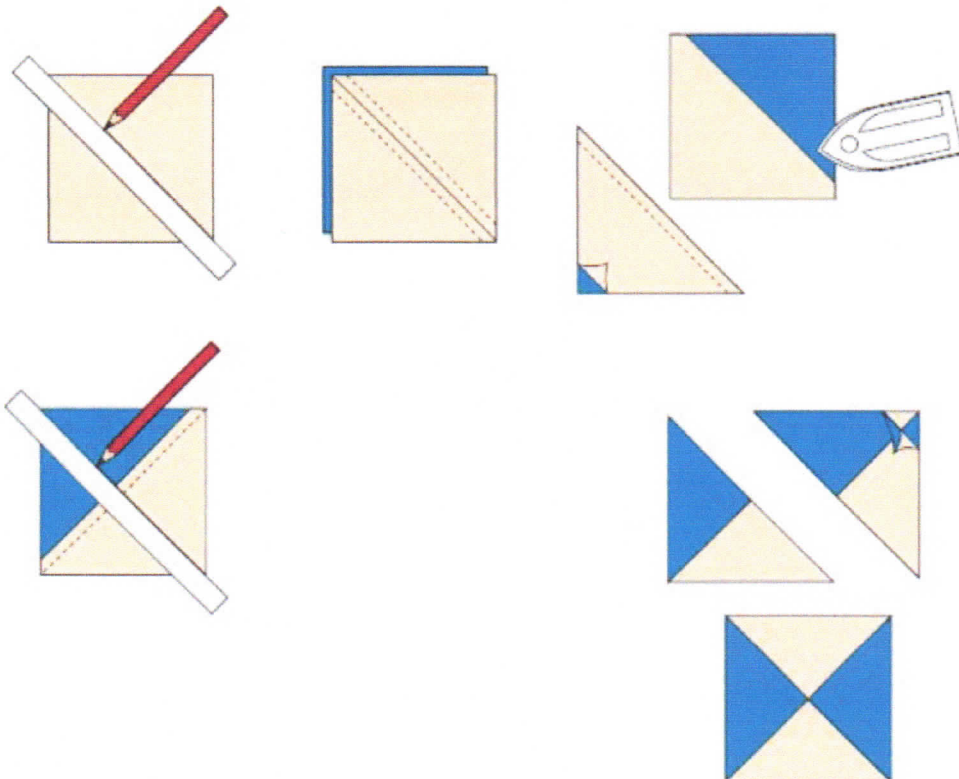

Le Moyne Star Ornament – Thangles

From white print, cut:

4 – 1 ¼" squares

1 ½" x 7" strip for thangles

From dark blue, cut:

1 ½" x 7" strip for thangles

From light blue, cut:

1 ½" x 7" strip for thangles

4 – 1 ¼" X 5" binding strips

1 - 4" square for backing

From batting, cut:

1 – 4" square

Using thangle paper, make 4 dark blue and white squares, 4 dark blue and light blue squares, and 4 light blue and white squares. Trim squares to measure 1 ¼". Sew squares together in rows to match diagram. Sew rows together.

Le Moyne with Half Squares

Key Block (83/100 actual size)

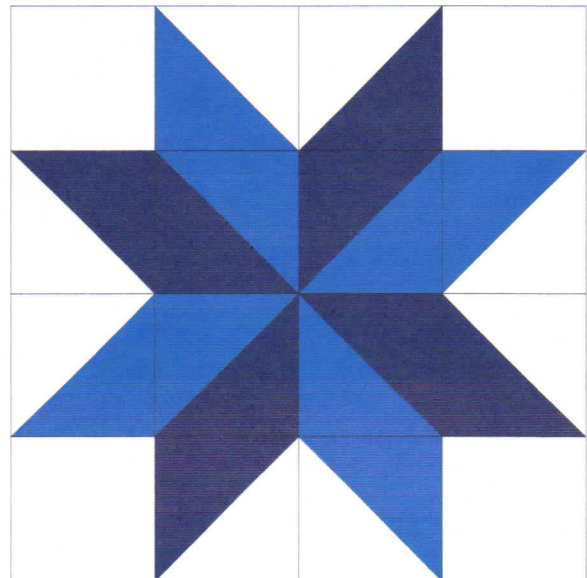
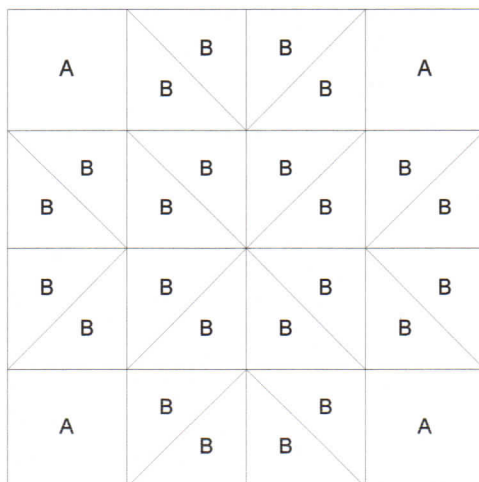

Le Moyne Star Ornament

From white print, cut:

8 – 1 3/4" x 1 1/4" rectangles

8 – 1 3/4" x 1 1/2" rectangles

From dark blue, cut:

4 – 2 1/4" x 1 1/2" rectangles

From light blue, cut:

4 – 2 1/4" x 1 1/2" rectangles

4 – 1 1/8" X 5" binding strips

1 - 4" square for backing

From batting, cut:

1 – 4" square

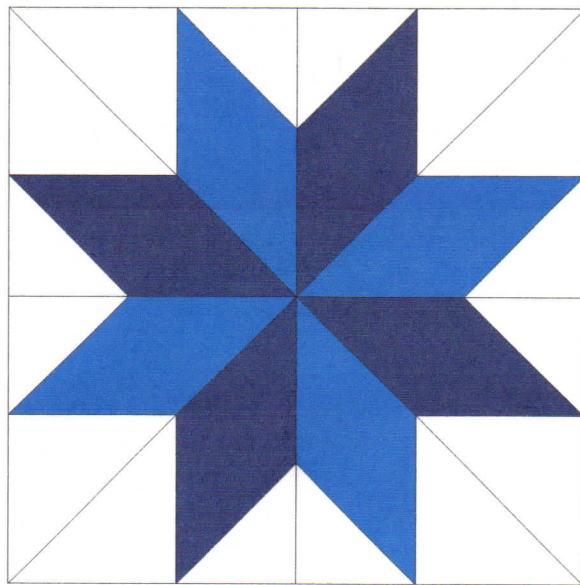

Using paper piecing techniques, construct sections A – H. Sew A to B, B to C, D to E, and G to H. Sew AB unit to CD unit and EF unit to GH unit. Sew ABCD unit to EFGH unit.

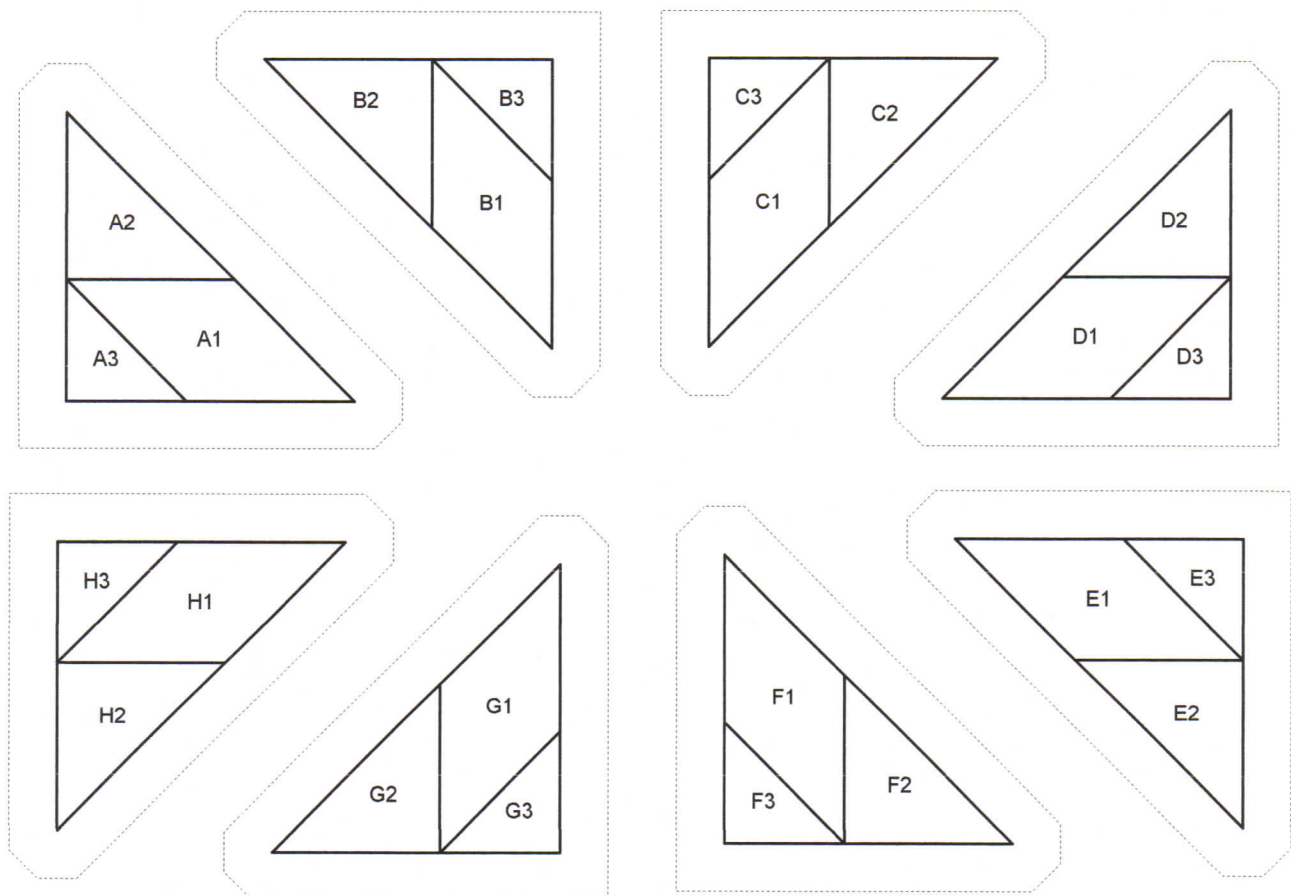

Eight-Pointed Star Ornament – Dark Blue

From white print, cut:

8 – 1 1/2" squares for corners and piece 1 on foundations

From dark blue, cut:

1 – 1 1/2" square for center

8 – 1 1/4" x 2" rectangles for star points

From light blue, cut:

4 – 1 1/4" X 5" binding strips

1 - 4" square for backing

From batting, cut:

1 – 4" square

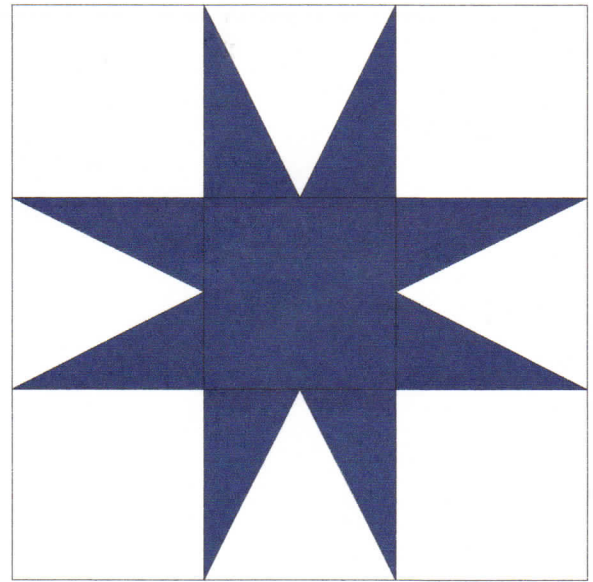

Using paper piecing techniques, make star point units by starting with white square as piece one and adding blue rectangles. Repeat to make four star point units. Trim along seam allowance line.

Sew together white 1 1/2" squares, star point units, and blue 1 1/2" square in three rows. Press seams away from star point units.

Join rows to make ornament top. Press seams toward center row.

